

Central High School

275 Lexington Parkway North

Project Summary:

Central is the oldest high school in the state of Minnesota, beginning its 150th year. Its rich traditions, including academic excellence, are widely celebrated. Families prize the high value we place on academics; the varied extracurricular opportunities; our culture of constant innovation; and our focus on relationships as the center for learning.

It was originally constructed in 1912 at 188,000 square feet. A later addition was completed in 1925 and a major renovation was completed in 1977. It is now 340,641 square feet.

Issues Identified By School Community In 2015

1. Safety and security
2. Indoor air quality unhealthy
3. Update of camera system
4. Furniture - fixtures and equipment
5. Improve all learning spaces
6. Bathroom improvements
7. True study hall space with desks and good lighting
8. Community and shared - open social space
9. Welcoming entrance and identity



Grade Levels: 9-12
SY 2014/15 Enrollment: 1858
Design Enrollment: 2160

General Notes:

Existing utilization shown is for School Year 2014-2015

The Conceptual Utilization Plans are exploratory rather than actual construction plans and represent the design at one moment in time, which will change as the design and funding process progress.

The Conceptual Plans are included as a way to organize scopes of work into logical, efficient and meaningful projects. There is no prioritization implied in a work scope title (e.g. "Work Scope A" is not necessarily the most critical work to be done).

The plans in this document are not comprehensive of the entire building's needs as maintenance and replacement of existing building systems such as roofs and mechanical systems are omitted to maintain graphic clarity of the overall vision generated during the Facilities Master Plan Process.

Formal zoning reviews have not been undertaken for the proposed work shown in these plans. A review with zoning and building code authorities will occur once the funding is secured.

Central High School Site Concept

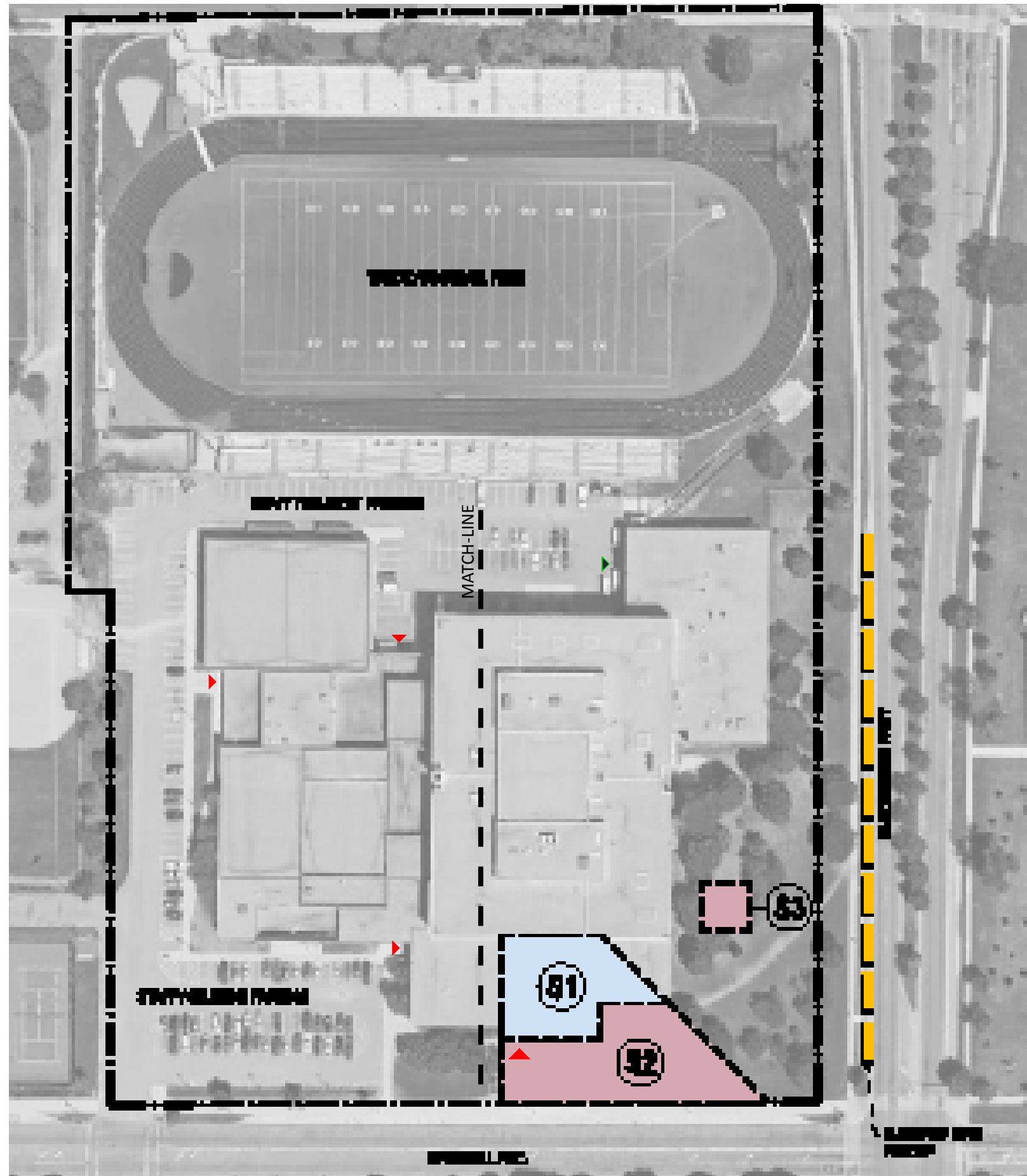

Legend:

- | | | |
|-----|--|-------------|
| S1. | New main entry, lobby, commons, and Instructional Space additions | (9,230 SF) |
| S2. | Incorporate Plaza retrofit (by others) into new landscape construction at Main Entry | (12,000 SF) |
| S3. | Relocate outdoor Instructional Space | (1,600 SF) |

- Property Line
- ▲ Main Entry
- ▲ Secondary Entry
- ▲ Service Entry

- Alterations
- New Landscape Construction
- New Building Construction

Central High School

Existing Utilization

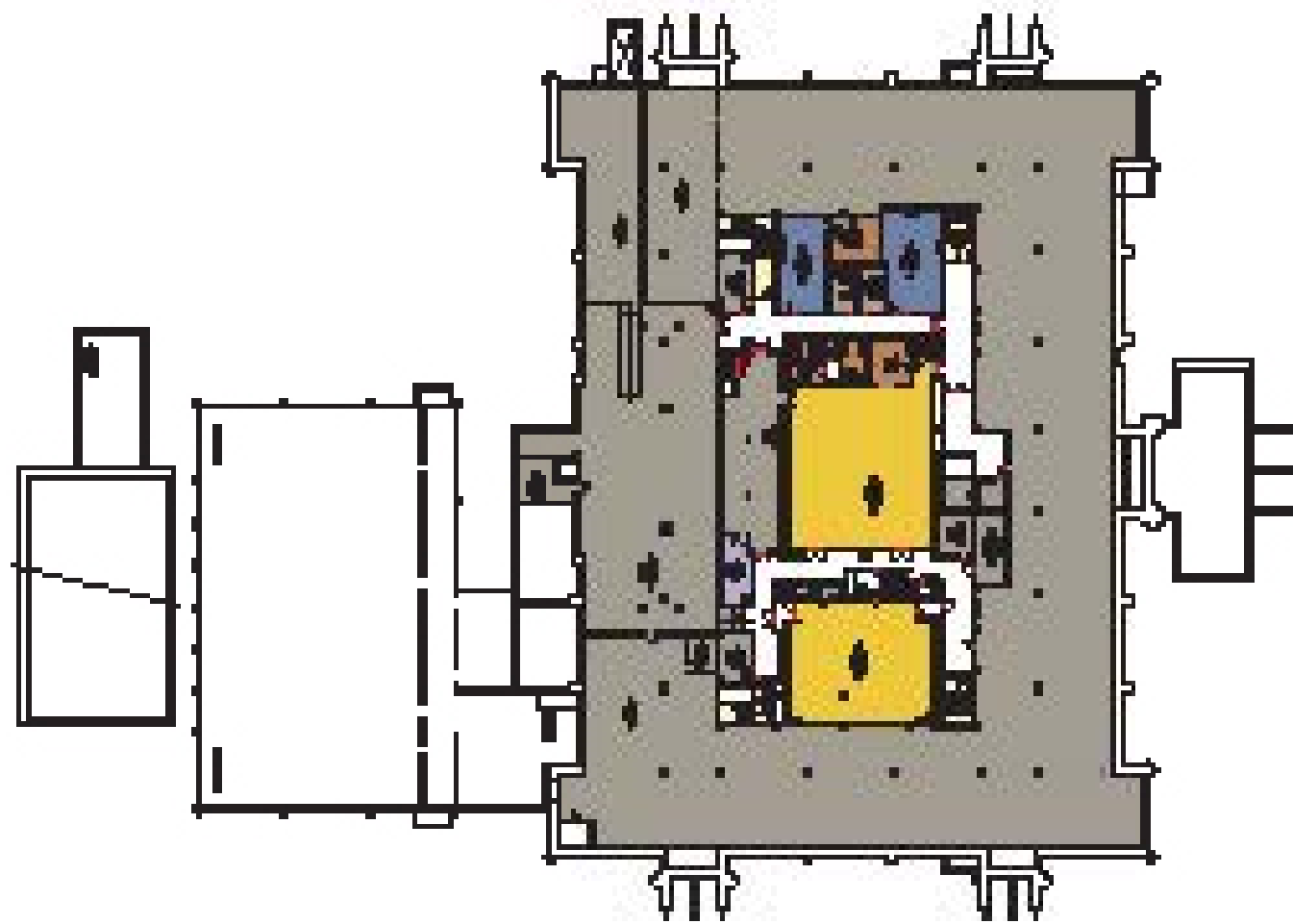

- General Learning
- Science
- Performing Arts
- Career & Tech Education
- Media Center
- Dining
- Athletics
- Circulation
- Facilities Support
- Administration
- Art

BASEMENT FLOOR

Central High School

Existing Utilization



FIRST FLOOR

- General Learning
- Science
- Performing Arts
- Career & Tech Education
- Media Center
- Dining
- Athletics
- Circulation
- Facilities Support
- Administration
- Art

Central High School

Existing Utilization



SECOND FLOOR

- General Learning
- Science
- Performing Arts
- Career & Tech Education
- Media Center
- Dining
- Athletics
- Circulation
- Facilities Support
- Administration
- Art

Central High School

Existing Utilization



THIRD FLOOR

- General Learning
- Science
- Performing Arts
- Career & Tech Education
- Media Center
- Dining
- Athletics
- Circulation
- Facilities Support
- Administration
- Art

Central High School

Existing Utilization

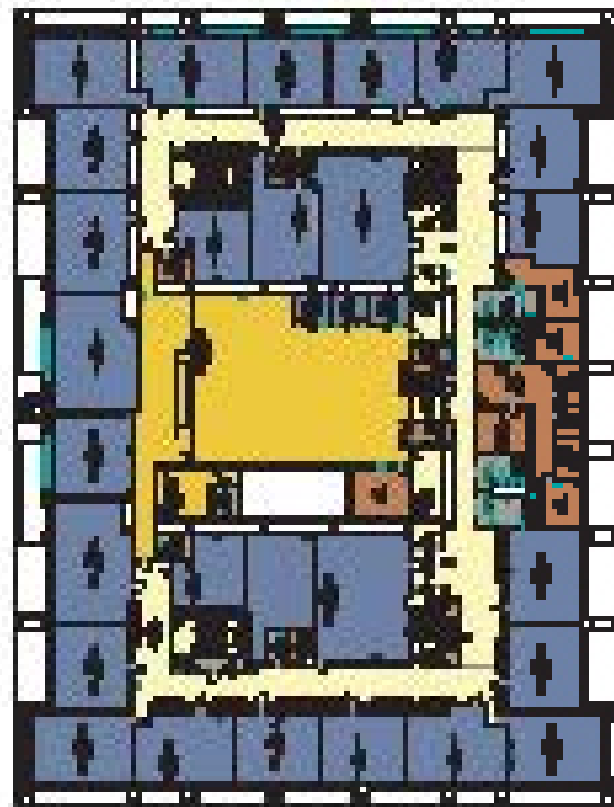

FOURTH FLOOR

- General Learning
- Science
- Performing Arts
- Career & Tech Education
- Media Center
- Dining
- Athletics
- Circulation
- Facilities Support
- Administration
- Art

Central High School

Conceptual Utilization Plan

Legend:

| | | |
|-----|---|------------|
| C1. | New Instructional Space | (1,194 SF) |
| C2. | Refurbish Instructional Space - furniture, lighting, equipment, aesthetics | (5,330 SF) |
| C3. | Restroom upgrades | (270 SF) |

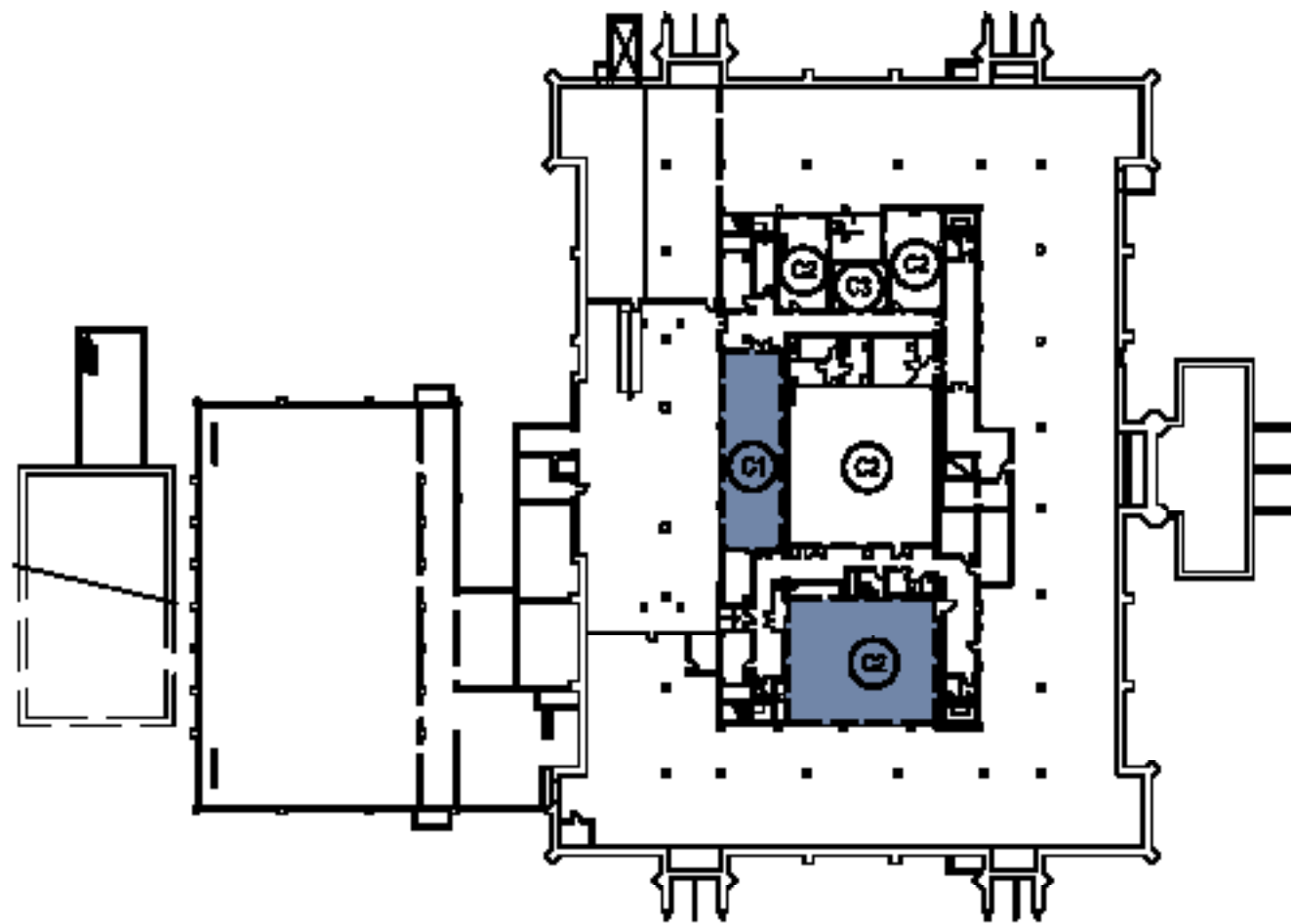

BASEMENT

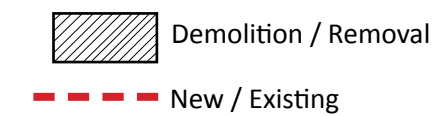

- General Learning
- Science
- Performing Arts
- Career & Tech Education
- Media Center
- Dining
- Athletics
- Circulation
- Facilities Support
- Administration
- Art



Central High School



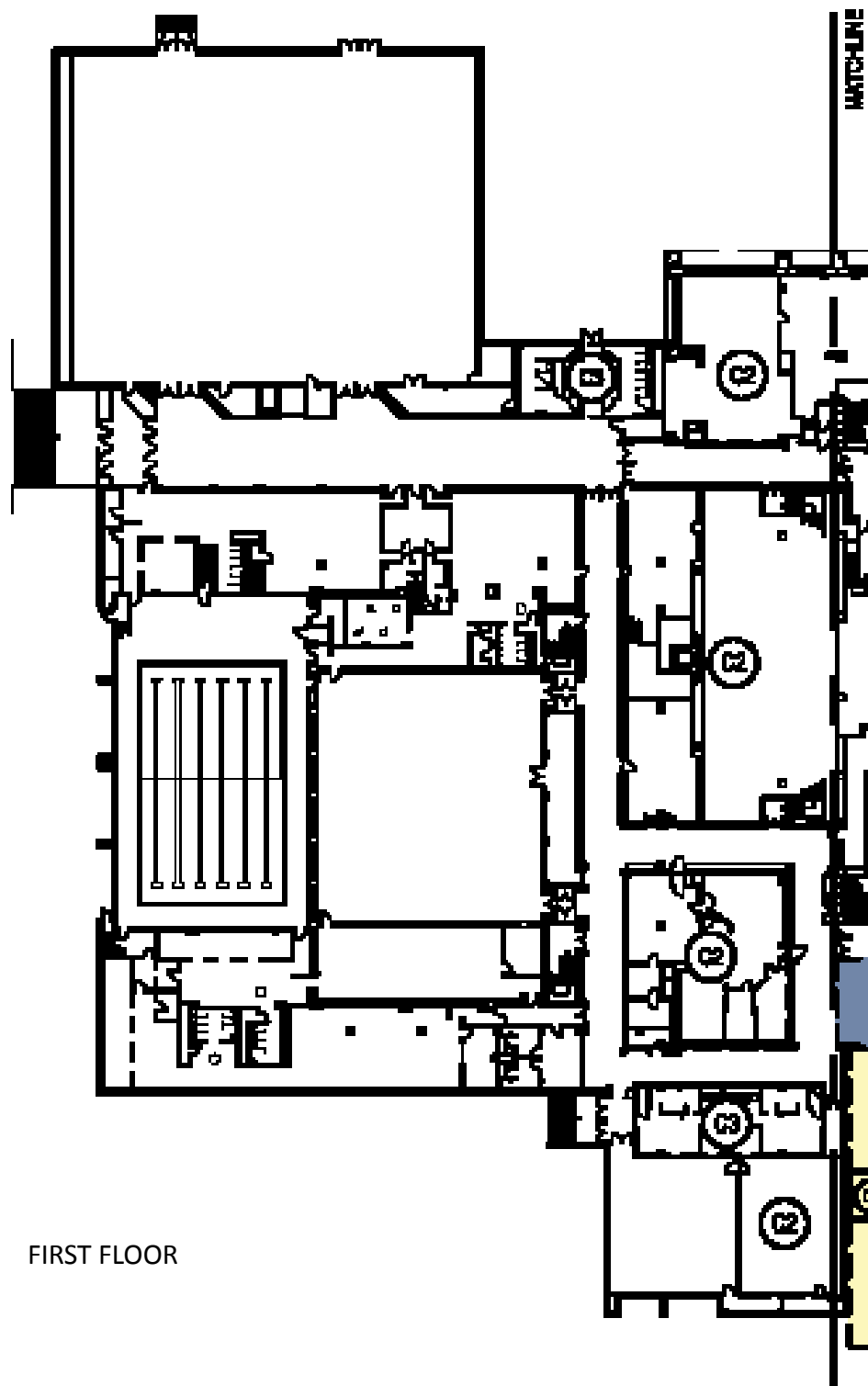











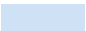

Conceptual Utilization Plan



FIRST FLOOR

Legend:

- C2. Refurbish Instructional Space - furniture, lighting, equipment, aesthetics (16,974 SF)
- C3. Restroom upgrades (2,286 SF)

| | | | |
|---|----------------------|---|-------------------------|
|  | Demolition / Removal |  | General Learning |
|  | New / Existing |  | Science |
|  | Property Line |  | Performing Arts |
|  | Main Entry |  | Career & Tech Education |
|  | Secondary Entry |  | Media Center |
|  | Service Entry |  | Dining |
| | |  | Athletics |
| | |  | Circulation |
| | |  | Facilities Support |
| | |  | Administration |
| | |  | Art |







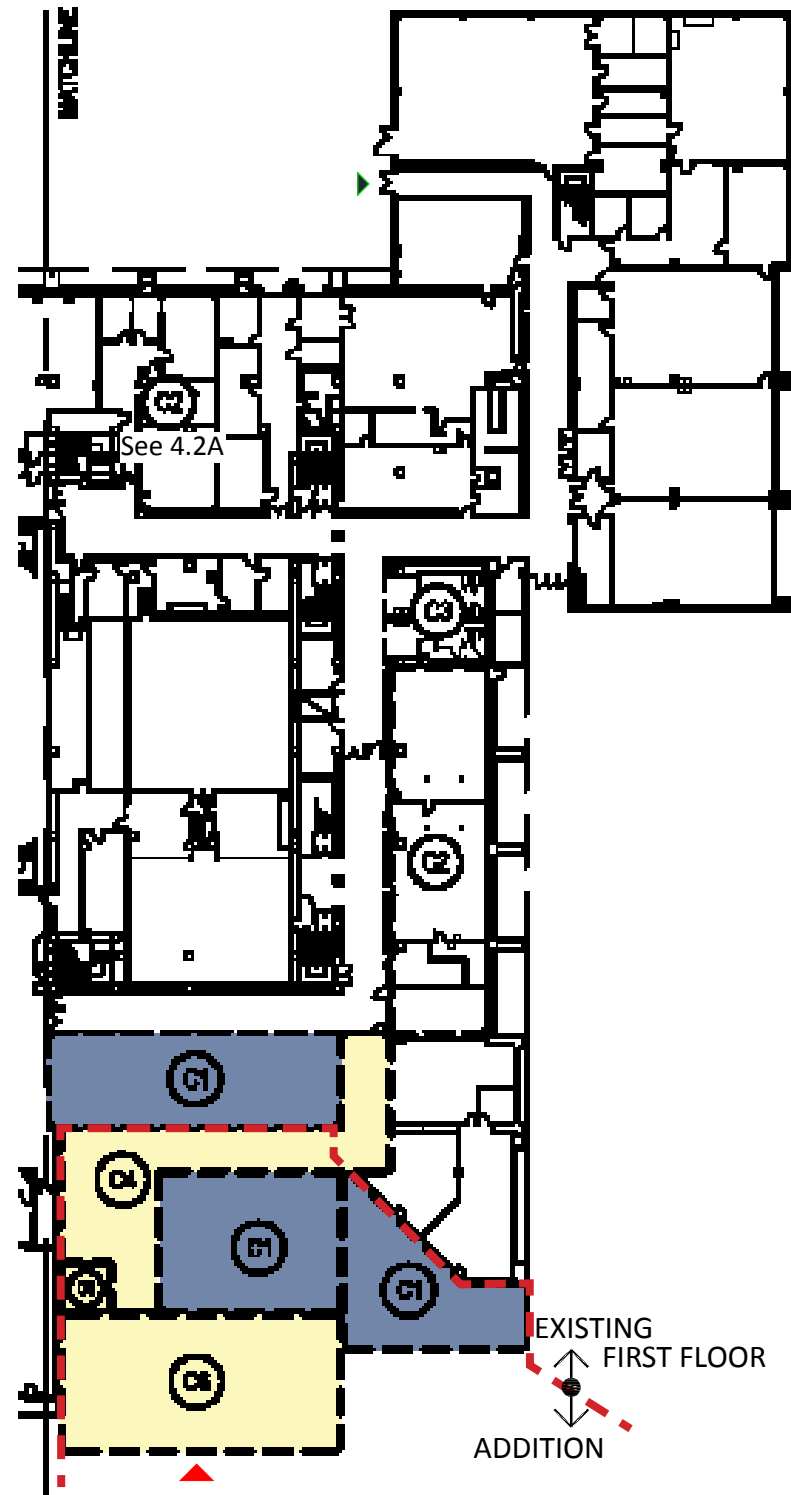









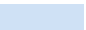

Central High School

Conceptual Utilization Plan



Legend:

| | | |
|-----|---|------------|
| C1. | New Instructional Space | (6,110 SF) |
| C2. | Refurbish Instructional Space - furniture, lighting, equipment, aesthetics | (3,000 SF) |
| C3. | Restroom upgrades | (903 SF) |
| C4. | New Corridor | (2,445 SF) |
| C5. | New Elevator | (200 SF) |
| C6. | New 2-story Entry Lobby and grand stair | (3,270 SF) |

| | | | |
|---|----------------------|---|-------------------------|
|  | Demolition / Removal |  | General Learning |
|  | New / Existing |  | Science |
|  | Property Line |  | Performing Arts |
|  | Main Entry |  | Career & Tech Education |
|  | Secondary Entry |  | Media Center |
|  | Service Entry |  | Dining |
| | |  | Athletics |
| | |  | Circulation |
| | |  | Facilities Support |
| | |  | Administration |
| | |  | Art |







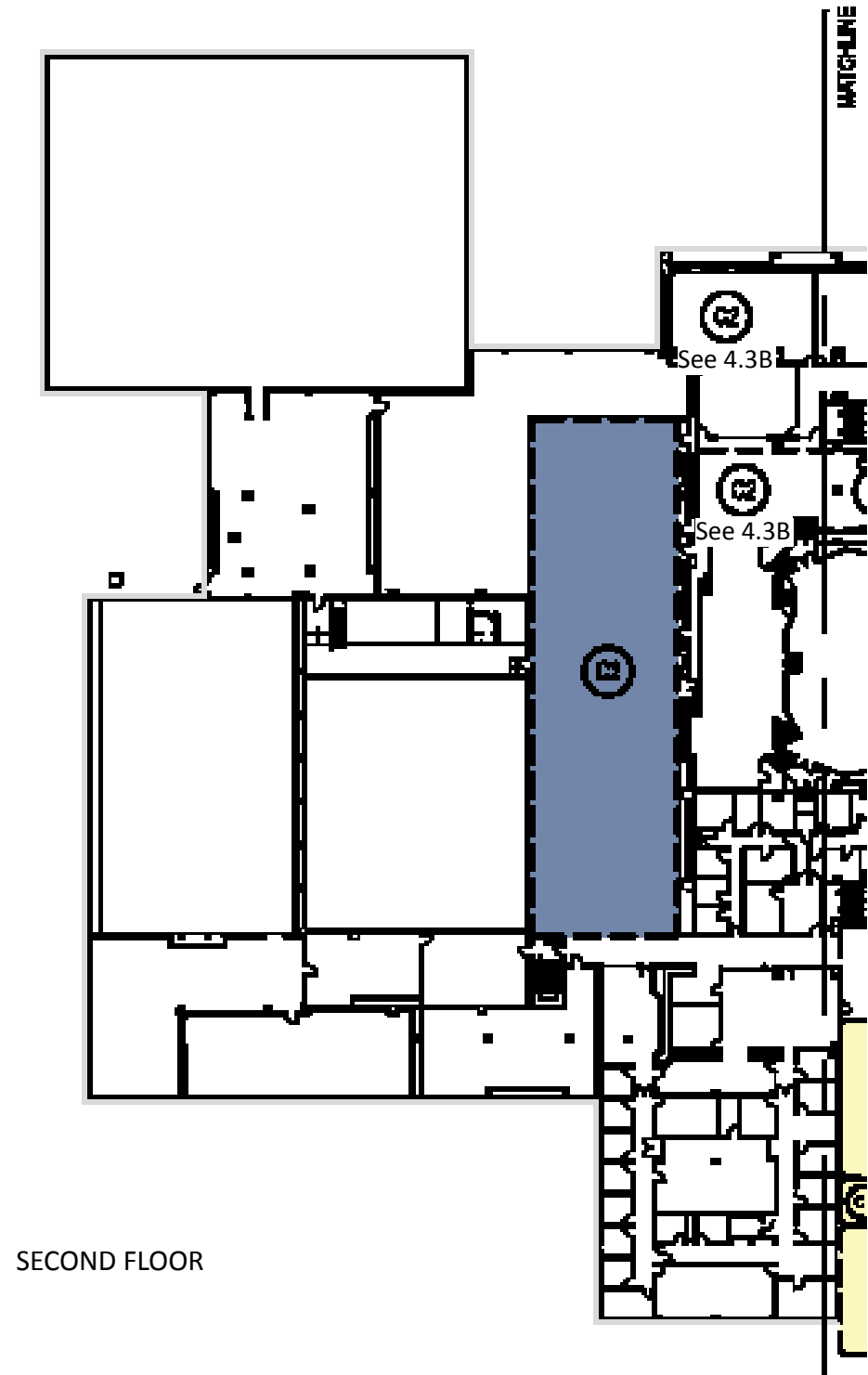





Central High School

Conceptual Utilization Plan



Legend:

C2. Refurbish Instructional Space -
furniture, lighting, equipment, aesthetics (7,404 SF)

| | |
|---|-------------------------|
|  | General Learning |
|  | Science |
|  | Performing Arts |
|  | Career & Tech Education |
|  | Media Center |
|  | Dining |
|  | Athletics |
|  | Circulation |
|  | Facilities Support |
|  | Administration |
|  | Art |

| | |
|---|----------------------|
|  | Demolition / Removal |
|  | New / Existing |



Central High School

Conceptual Utilization Plan

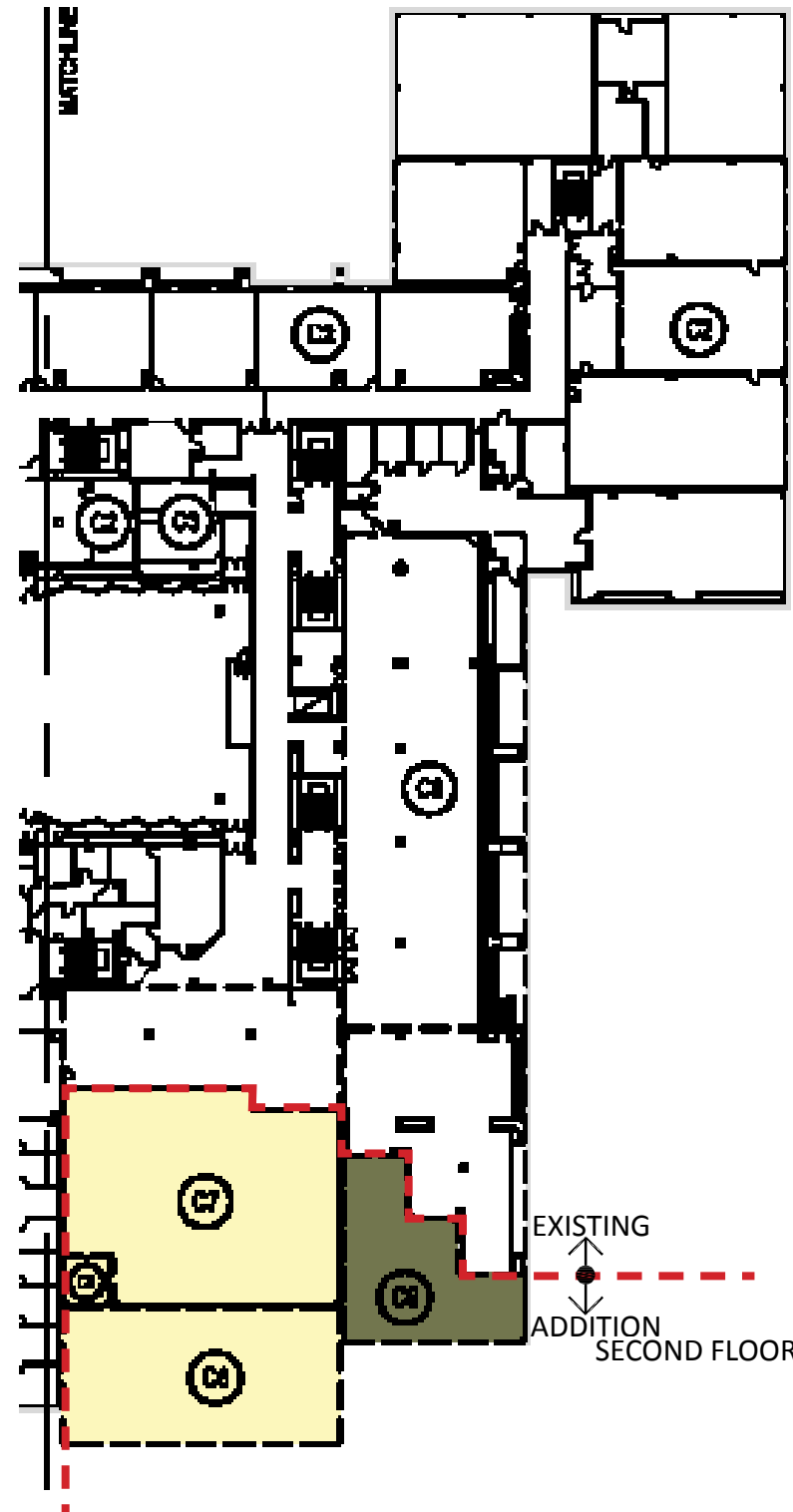

Legend:

| | | |
|-----|---|-------------|
| C2. | Refurbish Instructional Space - furniture, lighting, equipment, aesthetics | (13,932 SF) |
| C3. | Restroom upgrades | (997 SF) |
| C6. | New 2-story Entry Lobby and grand stair | (See 4.2B) |
| C7. | New Student Commons | (7,654 SF) |
| C8. | Upgrade Cafeteria | (7,786 SF) |
| C9. | Cafeteria expansion | (4,930 SF) |

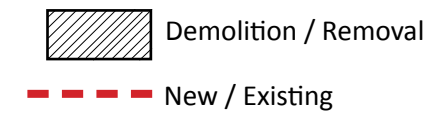

| | |
|---|-------------------------|
|  | General Learning |
|  | Science |
|  | Performing Arts |
|  | Career & Tech Education |
|  | Media Center |
|  | Dining |
|  | Athletics |
|  | Circulation |
|  | Facilities Support |
|  | Administration |
|  | Art |



Central High School

Conceptual Utilization Plan





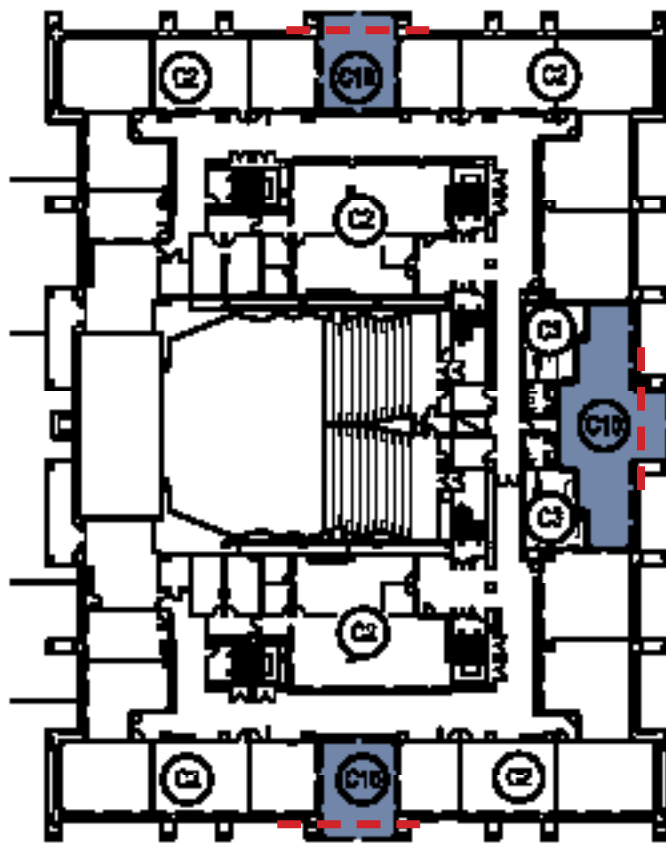





Legend:



- C2. Refurbish Instructional Space - furniture, lighting, equipment, aesthetics (16,268 SF)
- C3. Restroom upgrades (1,124 SF)
- C10. New shared centralized learning area (3,081 SF)



THIRD FLOOR



| | |
|---|-------------------------|
|  | General Learning |
|  | Science |
|  | Performing Arts |
|  | Career & Tech Education |
|  | Media Center |
|  | Dining |
|  | Athletics |
|  | Circulation |
|  | Facilities Support |
|  | Administration |
|  | Art |

| | |
|---|----------------------|
|  | Demolition / Removal |
|  | New / Existing |









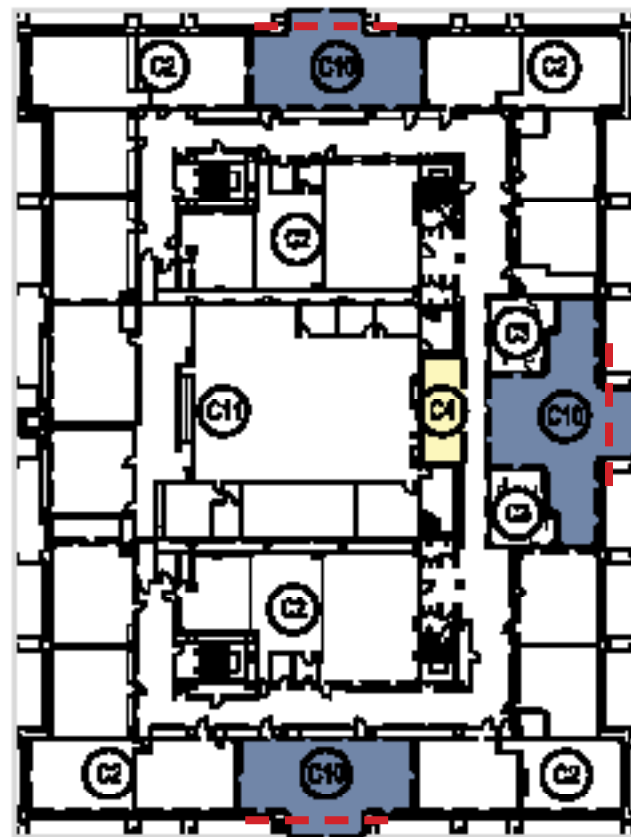

Central High School

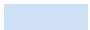

Conceptual Utilization Plan

Legend:

| | | |
|------|---|-------------|
| C2. | Refurbish Instructional Space - furniture, lighting, equipment, aesthetics | (17,509 SF) |
| C3. | Restroom upgrades | (912 SF) |
| C4. | New Corridor | (450 SF) |
| C10. | New shared centralized learning area | (4,798 SF) |
| C11. | Media Center upgrades | (8,496 SF) |



| | |
|---|-------------------------|
|  | General Learning |
|  | Science |
|  | Performing Arts |
|  | Career & Tech Education |
|  | Media Center |
|  | Dining |
|  | Athletics |
|  | Circulation |
|  | Facilities Support |
|  | Administration |
|  | Art |

| | |
|---|----------------------|
|  | Demolition / Removal |
|  | New / Existing |

FOURTH FLOOR

